

TYPE 1 ROLLED CURB & GUTTER (CITY STD. DETAIL)
N.T.S.

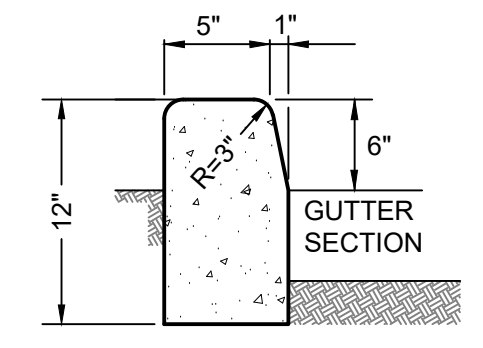

VERTICAL CURB DETAIL
N.T.S.

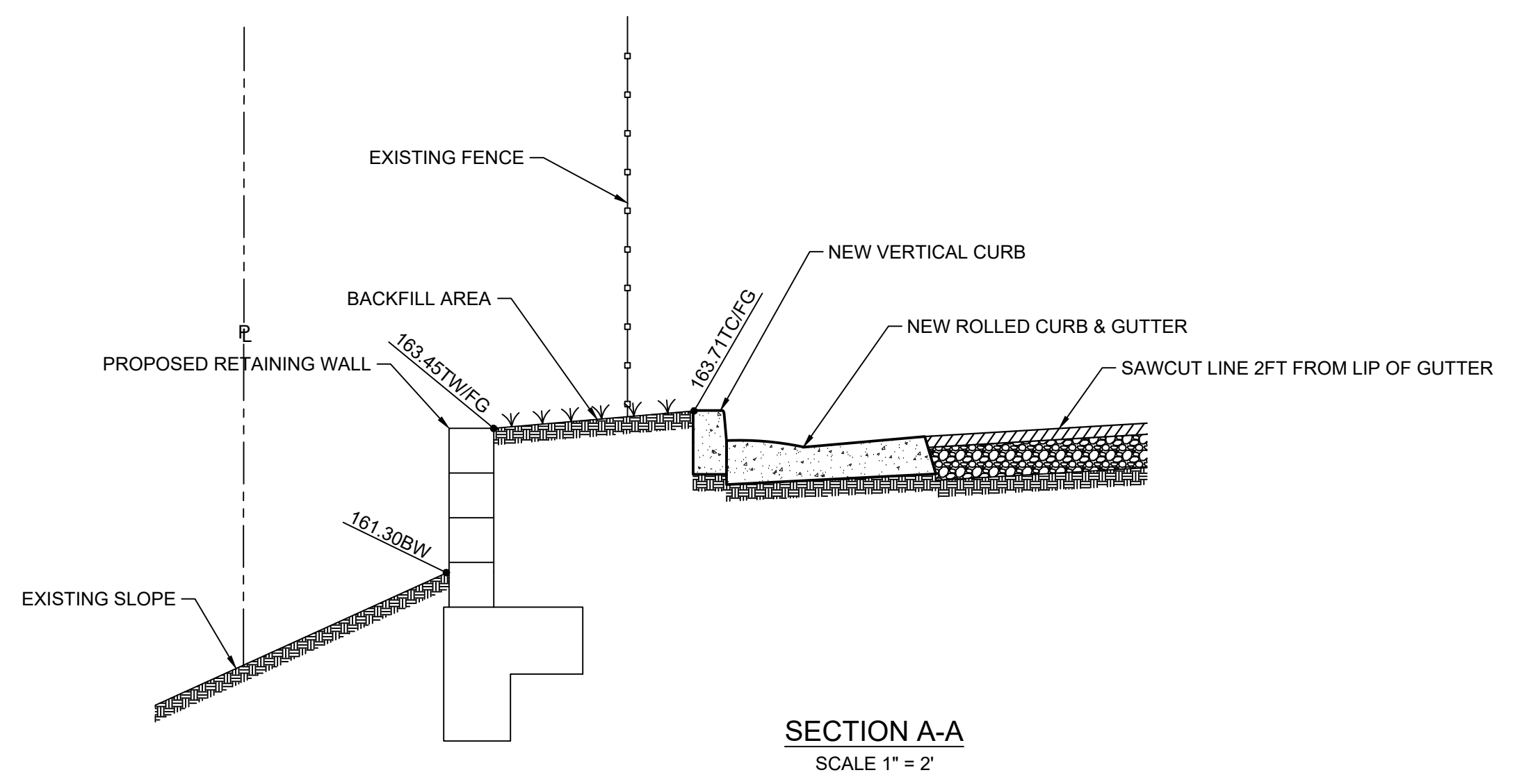

SECTION A-A
SCALE 1" = 2"

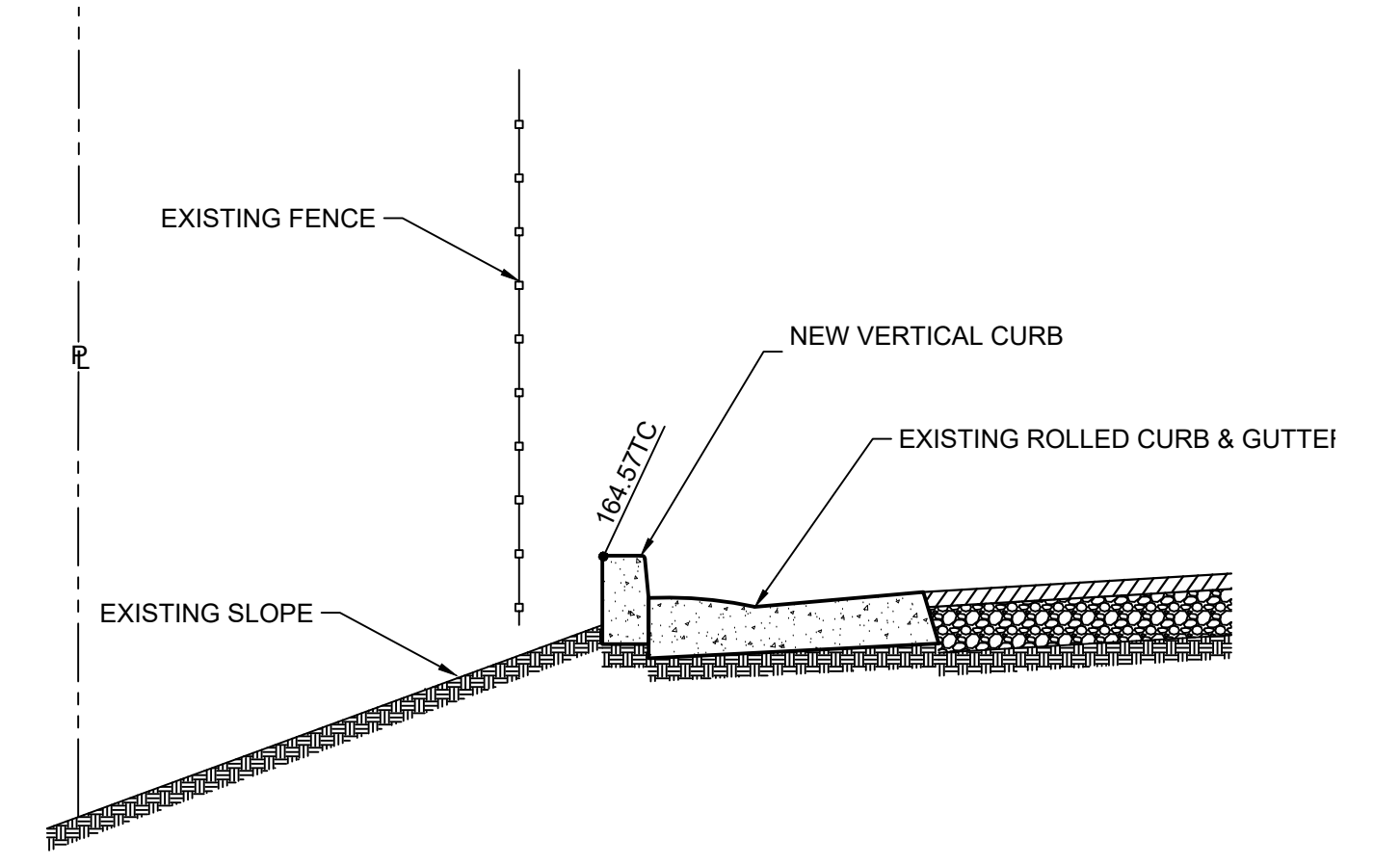

SECTION B-B
SCALE 1" = 2"

- LEGEND:**
- SCORE MARK, 1/8" DEEP
 - SUBGRADE PROCESSED TO 95% RELATIVE COMPACTION.
 - ALL SIDEWALK HAS OPTION OF 4" CONCRETE ON 4" AGGREGATE BASE, IN LIEU OF 6" CONCRETE ON NATIVE.
 - GUTTER PAN CROSS SLOPE NOT TO EXCEED 5% MAX, OR BE LESS THAN 4%.

CONSTRUCTION NOTES

- INSTALL NEW 6" VERTICAL CURB FROM NORTH EASTERN LIMIT OF IRON FENCE TO WESTERN LIMIT OF SAWCUT LINE. SEE DETAIL THIS SHEET.
- INSTALL NEW ROLLED CURB AND GUTTER. SEE DETAIL THIS SHEET.
- INSTALL CMU RETAINING WALL. SEE DETAIL THIS SHEET.
- BACKFILL AND COMPACT SOIL TO GRADE.
- INSTALL NEW AC&AB - AC SHALL BE 2" TYPE A PER CITY STANDARD SECTION 7-4. TABLE 7-2. NEW AB SHALL MATCH EXISTING CLASS II AB THICKNESS AND COMPLY WITH CALTRANS SECTION 25 & 26 PER CITY STANDARD SECTION 71-4.

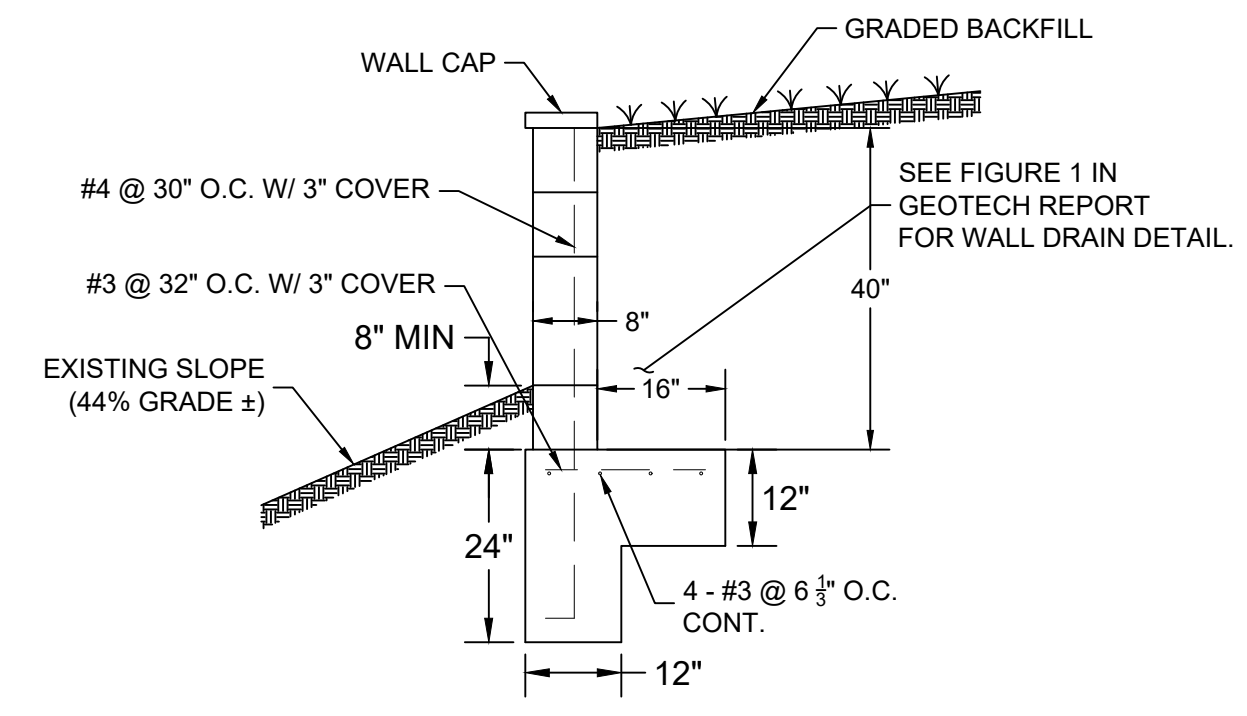

CMU RETAINING WALL DETAIL
SCALE 1" = 2"

ADVISE: ROSEVILLE ELECTRIC HAS FACILITIES ON THE SOUTHEAST SIDE OF THE ALLEY WAY.

CONSTRUCTION LEGEND

- LIMITS OF BACKFILL AND GRADING.
- LIMITS OF AC/AB REPLACEMENT.
- LIMITS OF CONCRETE CURB & GUTTER IMPROVEMENT.
- CMU WALL.

| IMPORT QUANTITY | |
|-----------------|------------|
| FILL | 15 CY |
| NET | 15 CY FILL |

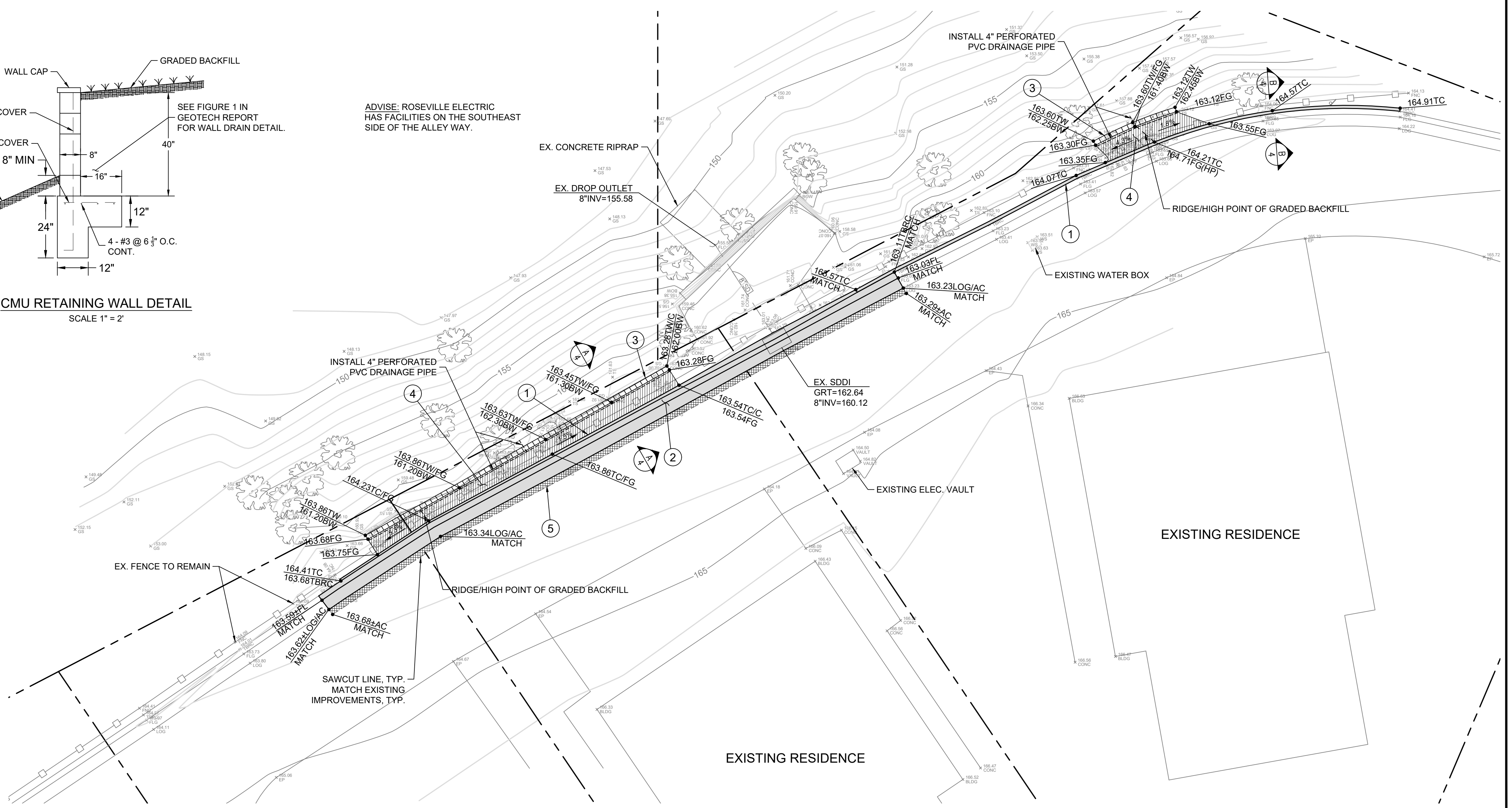
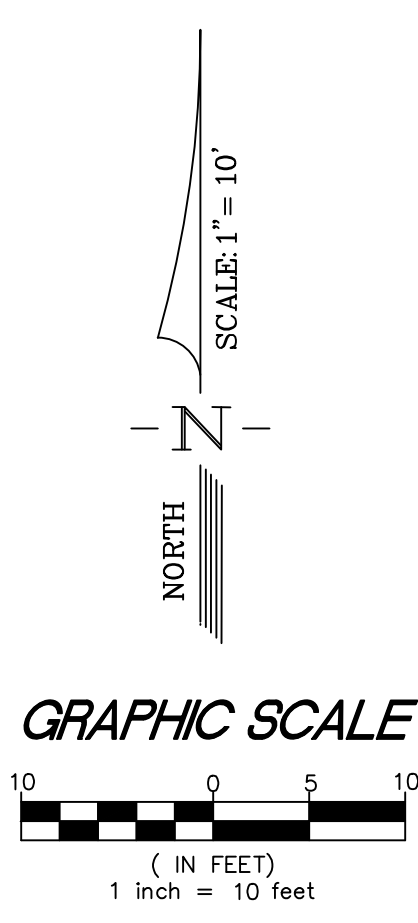

| No. | Description | Engr Init | COUNTY APPROVAL |
|-----|-------------|-----------|-----------------|
| | | | By Date |
| | | | |
| | | | |
| | | | |

BENCHMARK DESCRIPTION
CITY BENCHMARK 80:
ELEV. = 162.58
3" BRASS DISC STAMPED "2018 PLS 8278" ON DRY CREEK AT HARDING BLVD. NORTHEAST CORNER OF BRIDGE AT BACK OF SIDEWALK.

DESIGNED R. HUCK
DRAWN R. HUCK
CHECKED D. DOSEN
DATE 3/8/19
SCALE 1" = 10'

PRELIMINARY DRAWING
FOR PLAN CHECK SUBMITTAL ONLY
NOT FOR CONSTRUCTION

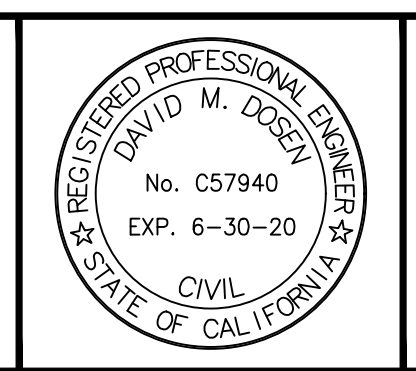

SGI COMPANIES
SGI CIVIL • SGI 3D • SURVEYORS GROUP, INC.
9001 Foothills Blvd., Suite 170
Roseville, CA 95747
(916) 789-0822 (916) 789-0824 (Fax)
www.sgicompanies.com

ROSEVILLE GREENS HOMEOWNER'S ASSOCIATION
IMPROVEMENT PLANS
265 SHARP CIRCLE
ROSEVILLE, CALIFORNIA
GRADING AND DRAINAGE PLAN

SHEET NO. C-4 OF 5
JOB NO. BST 18-89